

Dewdrops Chandelier Circular 05 Bubbles

DDCHCR05

IP20

Materials

Hand blown transparent borosilicate glass and hand finished or electroplated brass.

Weight incl. canopy

~12.5 lbs

Power Input

110-120V 50-60Hz

Light Source (included)

5 LED Glass Drops, 2 LED UpSpots. 20W, 1650 Lumens, 2700K warm white. CRI>90.

Note: Each dewdrops installation will move even in a slight breeze, similar to a mobile. It is not recommended for windy interiors.

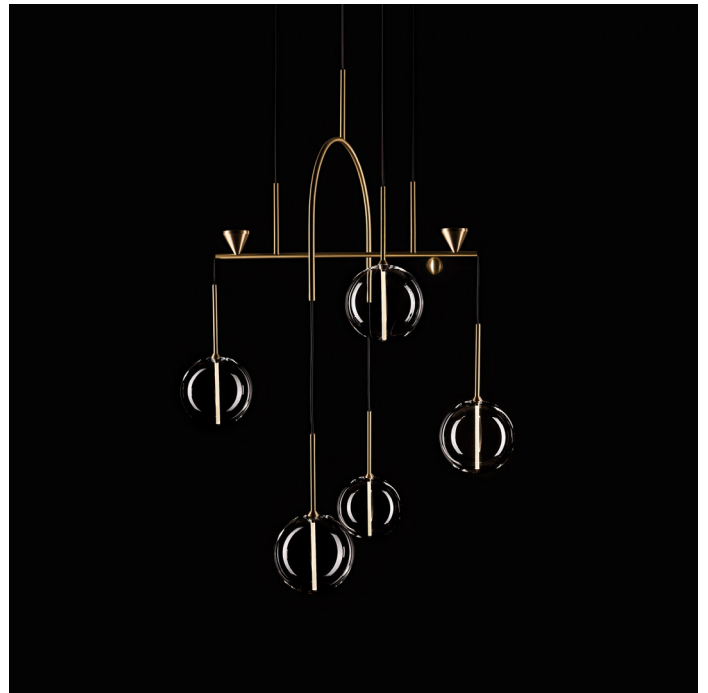

DEWDROPS CHANDELIER CIRCULAR 05 BUBBLES

CONFIGURATION

STEP 1 - CHOOSE YOUR METAL FINISH



SIZE (UNIT: IN)

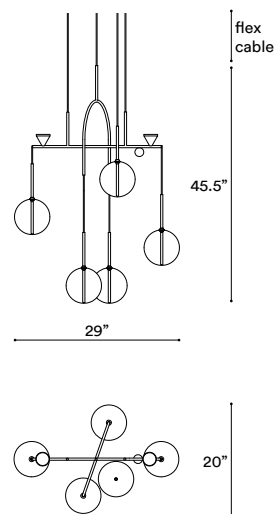

STEP 2 - CHOOSE YOUR SUSPENSION TYPE

SUSPENSION TYPE



Black Fabric Flex Cable

Drop height adjustable on site:

157"

393"



White Fabric Flex Cable

Drop height adjustable on site:

157"

393"

+ **Single canopy with built-in phasecut driver.** Recommended.

Ø12" X H2"



WHITE RAL 9016



MATCHING FINISH



+ **Single canopy with built-in driver and alternative dimmable standard,** if required by electrician.

Ø12" X H2"



WHITE RAL 9016



MATCHING FINISH



Brushed Brass

Brass hand finished with horizontal brushing. Protected with a semi-gloss transparent coating.

Brushed Bronze

Brass with accelerated aging to become a bronze finish. Hand finished with horizontal brushing. Protected with a semi-matt transparent coating.

Blackened Brass

Brass with accelerated aging to become an extra dark chocolate finish. Hand finished with horizontal brushing. Protected with a semi-matt transparent coating.

Brushed Nickel

Electroplated nickel over Brass with horizontal brushing. Protected with a semi-gloss transparent coating.

Polished Nickel

Electroplated Nickel over polished brass. Protected with a semi-gloss transparent coating.

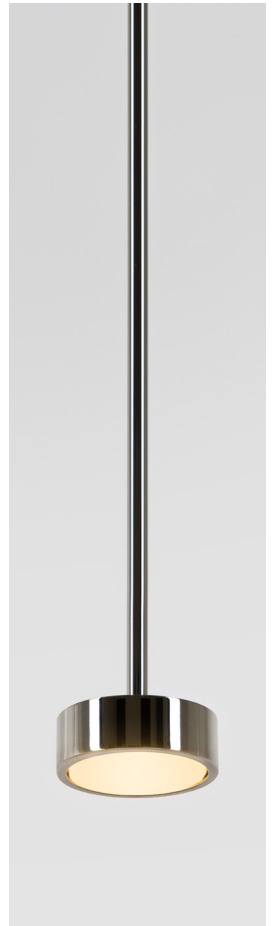

Custom Finish

Our products can be customized with most metal finishes, please check with our design advisors if you have any particular requirement.

Please advise if our products are to be installed close to air conditioning vents or in windy or salty air conditions.